

TOWN AND COUNTRY PLANNING ACT 1990

THE STOPPING UP OF HIGHWAYS (YORKSHIRE AND HUMBER) (NO.8) ORDER 2021

The Secretary of State makes this Order in exercise of powers under section 247 of the Town and Country Planning Act 1990 ("the Act").

1. The Secretary of State authorises the stopping up of the highways described in the Schedule to this Order and shown on the plan numbered NATTRAN/Y&H/S247/4378, to enable development to be carried out in accordance with the planning permission granted by Sheffield City Council under references 20/01895/RG3, 20/01437/RG3, 20/01438/LBCRG3.

2. The developer shall to the reasonable satisfaction of Sheffield City Council provide: -
 - (a) new highway as proposed and detailed in the approved planning permission, development plans and associated legal agreements with the Council; and
 - (b) improvement of the highway as proposed and detailed in the approved planning permission, development plans and associated legal agreements with the Council.

3. Where immediately before the date of this Order there is any apparatus of statutory undertakers under, in, on, over, along or across any highway authorised to be stopped up pursuant to this Order then, subject to section 261(4) of the Act, those undertakers shall have the same rights as respects that apparatus after that highway is stopped up as they had immediately beforehand.

4. This Order shall come into force on the **20 April 2021**.



Signed by authority of
the Secretary of State
08 April 2021

DENISE HOGGINS
An Official in the
National Transport Casework Team
Department for Transport

THE SCHEDULE

Description of highways to be stopped up

The highways to be stopped up are at Sheffield in the City of Sheffield, shown on the plan as:

1. The whole of Backfields Link. It is marked 1 on the plan.
2. A length and part width of Backfields. Commencing from its junction with Wellington Street, it extends in a north westerly direction for a maximum distance of 62 metres. It has a maximum width of 4.5 metres. It is marked 2 on the plan.
3. A length of Bethel Walk. Commencing from its junction with Backfields, it extends in a north easterly direction for a maximum distance of 46 metres. It is marked 3 on the plan.

A3

A

B

C

D

E

F

G

HIGHWAYS AT SHEFFIELD IN THE CITY OF SHEFFIELD

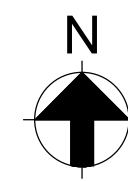

1

2

3

4

5

6

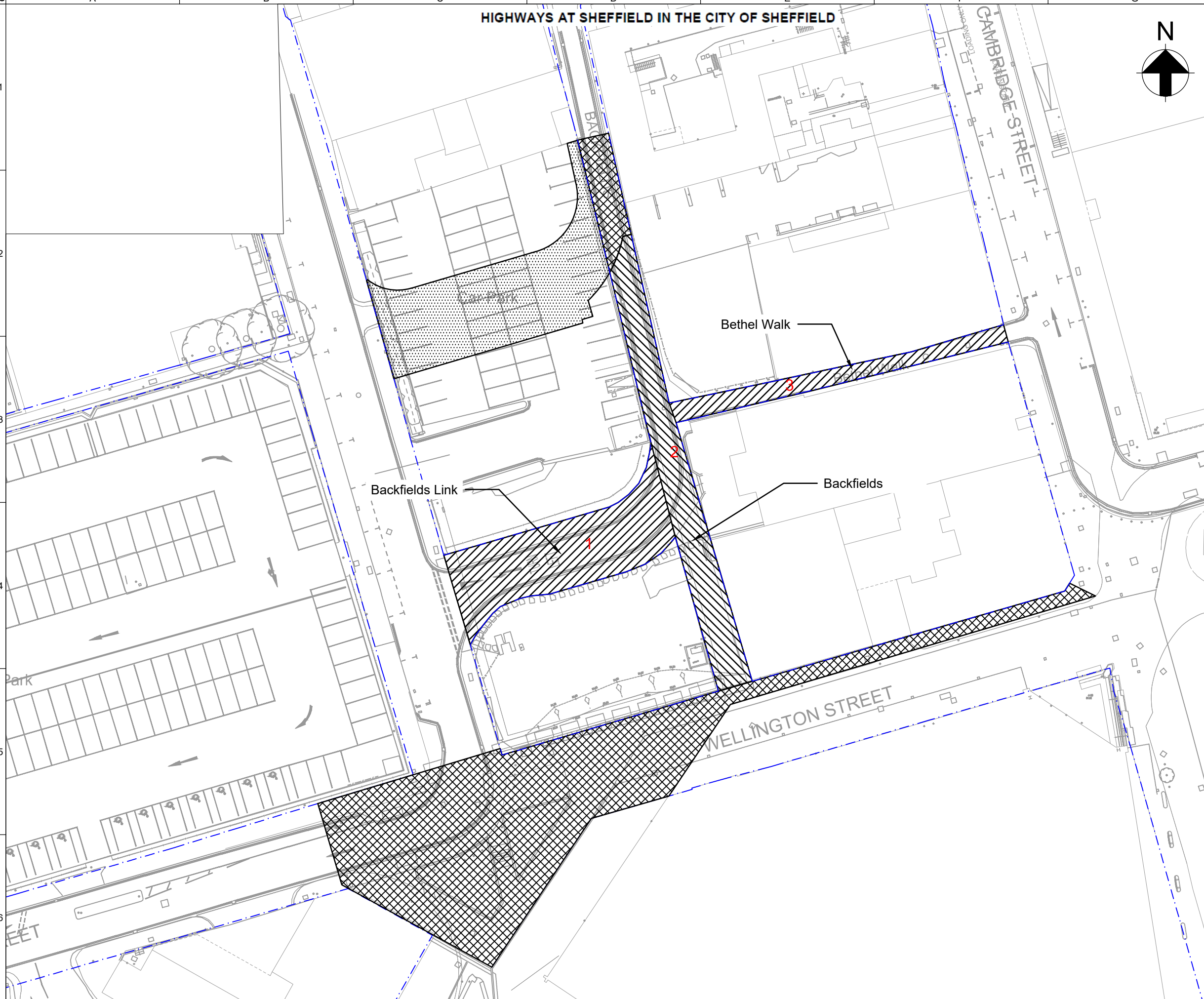

Key Scale 1:500 @ A3

Highways to be stopped up 

Proposed highway to be improved 

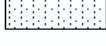
Proposed new highway 

National Transport Casework Team

Department for Transport

Plan No:
NATTRAN/Y&H/S247/4378

Signed by Authority of the Secretary of State
on 8 April 2021

Signature..... *Denise Hoggins*

DENISE HOGGINS
An Official in the
National Transport Casework Team
Department for Transport