

**Tree Preservation Order**

**Town and Country Planning Act 1990**

**The Tree Preservation Order No 478 (2024)**

**Norton House Country Club, 246-248 Norton Lane,**

**Sheffield, S8 8HD**

The Sheffield City Council, in exercise of the powers conferred on them by section 198 of the Town and Country Planning Act 1990 make the following Order —

**Citation**

1. This Order may be cited as Tree Preservation Order No 478 (2024) – Norton House Country Club, 246-248 Norton Lane, Sheffield, S8 8HD.

**Interpretation**

2. (1) In this Order “the authority” means the Sheffield City Council.  
(2) In this Order any reference to a numbered section is a reference to the section so numbered in the Town and Country Planning Act 1990 and any reference to a numbered regulation is a reference to the regulation so numbered in the Town and Country Planning (Tree Preservation)(England) Regulations 2012.

**Effect**

3. (1) Subject to article 4, this Order takes effect provisionally on the date on which it is made.  
(2) Without prejudice to subsection (7) of section 198 (power to make tree preservation orders) or subsection (1) of section 200 (tree preservation orders: Forestry Commissioners) and, subject to the exceptions in regulation 14, no person shall—
  - (a) cut down, top, lop, uproot, wilfully damage, or wilfully destroy; or
  - (b) cause or permit the cutting down, topping, lopping, uprooting, wilful damage or wilful destruction of,any tree specified in the Schedule to this Order except with the written consent of the authority in accordance with regulations 16 and 17, or of the Secretary of State in accordance with regulation 23, and, where such consent is given subject to conditions, in accordance with those conditions.

**Application to trees to be planted pursuant to a condition**

4. In relation to any tree identified in the first column of the Schedule by the letter “C”, being a tree to be planted pursuant to a condition imposed under paragraph (a) of section 197 (planning permission to include appropriate provision for preservation and planting of trees), this Order takes effect as from the time when the tree is planted.

Dated 9<sup>th</sup> May 2024

EXECUTED AS A DEED  
By Sheffield City Council  
whose common seal was  
hereunto affixed in the presence of

)  
)  
)  
)  
)



Duly Authorised Signatory

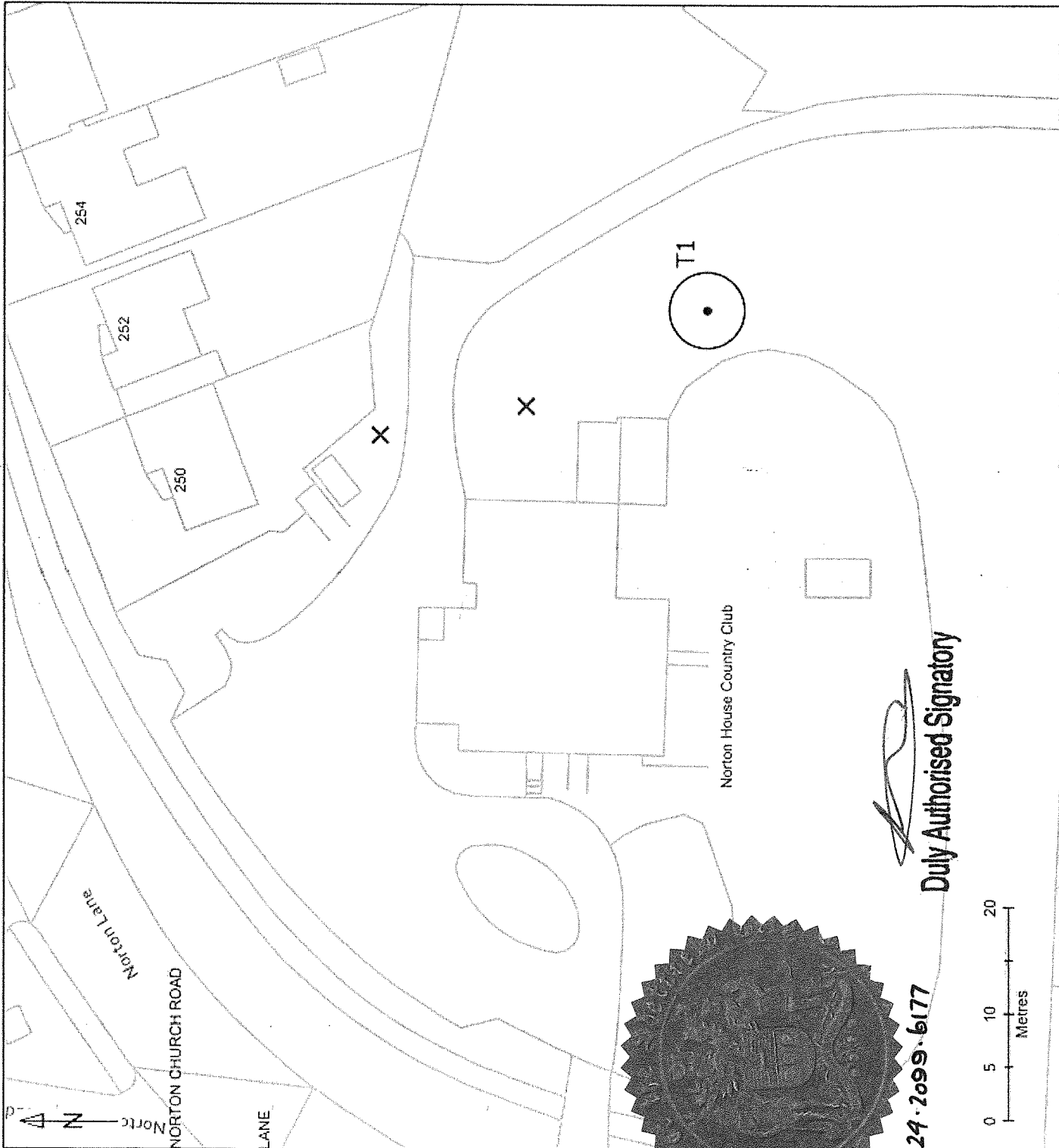

<p>Sheffield City Council Parks &amp; Countryside Service</p> <p>Sheffield City Council Parks &amp; Countryside</p>	<p><b>TREE PRESERVATION ORDER</b> No. 478</p> <p>Drawing No. <b>A4/808/478</b></p> <p>Site address <b>246 - 248 Norton Ln, Norton, Sheffield S8 8HD</b></p> <p>Scale: <b>1:500 @ A4</b></p> <p>Drawn by MB      Date: 07/05/2024</p> <p>Trees specified individually (circled in black on the plan)</p> <p><b>T1: Ash (<i>Fraxinus excelsior</i>)</b></p> <p>Trees specified by reference to a group - None Trees specified by reference to an area - None Trees specified by reference to a woodland - None</p> <p>X = tree not included within the TPO</p>
<p>SK 35996 82036</p> <p>Measurements shown approximately</p>	